



## INSTALLATION INSTRUCTIONS Pet Pass Thru model

*The following is a step by step guide for installing your Pet Pass Thru product.*

### **A SAFETY REMINDER!**

**Always wear eye protection and gloves when appropriate.**

### **Section A: Door Installation**

**Step 1:** Be sure that you have ordered the correct size door for your pet. For long term use it is best to size the pet door so that the top of the door is about 2 inches taller than your pet's shoulders.

**Step 2:** Check the package you received to make sure that it contains all the necessary parts.

### **Complete Kit includes:**

Instructions  
Pet Pass Thru Model  
1-1/4" #6 Phillips Head Screws  
1-1/4" #6 Security Screws for Tamper proof installations  
7/64" drill bit  
Allen Wrench (*included with flap models*)

### **Tools Needed:**

Saw (Reciprocating or Jigsaw)  
Pencil  
Electric Drill  
(Drill Bit large enough to create a "start" hole for the saw)  
Level  
Caulk (if desired)  
Phillips Head Screw driver

**Step 3:** Find a suitable area for your cat door model. Position the location of the rough opening such that it is no closer to the vertical edge of the door than 3" to maintain structural strength within the door. ***In hollow core wood doors, the bottom edge of the door has a solid piece of wood spanning the width of the door. You will be anchoring the cat door into this solid wood.***

**Step 4:** Trace the flange of the Pet Pass Thru door using a pencil. Be sure the legs of the Pet Pass Thru door frame do not extend past the bottom edge of the door it is being installed into; this will keep the pet door from catching on carpet. Use the dimension of the flange perimeter to determine the dimension of the rough opening.



**Step 5—WOOD DOORS:** For wood doors, drill out two corners diagonal from each other using a 7/8” paddle bit or a 5/16” regular bit. If you use a regular bit, drill three holes close together then elongate the holes until you have connected the three holes. This will allow insertion of the reciprocating saw blade. Cut out the rough opening along the traced lines.



**Step 5—METAL DOORS:** For metal doors, follow the above directions for wood doors, using an appropriate blade made for cutting metal.

**Step 6:** Separate the Interior and exterior door frames.

**Step 7:** Put the inner frame (the one with no pilot holes) into the rough opening in the people door. Snap the outside frame into Pet Pass Thru door and sleeve the pet door frame together.



**Step 8:** Using the pre-drilled pilot holes and supplied drill bit, drill and insert one screw into one leg of the Pet Pass Thru Cat door so that it anchors in the solid wood along the bottom edge of the door (As Mentioned in Step 3) Make sure the door is level. When level, tighten the inserted screw. Repeat with other leg of cat door. Affix remaining screw into place using the pilot hole as guide.

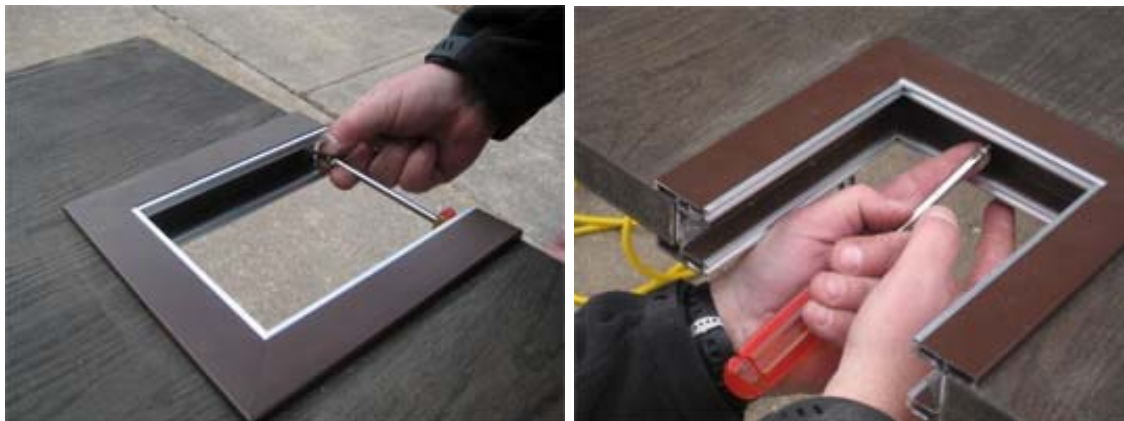

**Step 9:** Once the pet door is installed you can fill any gaps or seal the edges with caulking if desired.

### **MAINTAINENCE:**

The Thumbscrews that attach the optional flap are factory tightened. Through use, the thumbscrews occasionally loosen and therefore should be checked regularly for tightness. Retighten the thumbscrews using the included Allen wrench.



You have now installed your new Pet Pass Thru Door.

**DISCLAIMER:**

**Child Safety:**

Security Boss® Manufacturing, LLC., recommends that households with small children need to exercise proper judgment with leaving their children unattended in any area with a pet door. .

**Installation:**

We recommend that any consumer that installs their own pet door wear eye protection and be familiar with the construction procedures and tools of installing a pet door.

If you have any questions or are unclear about these safety statements please call our Distributor: Moore Pet Supplies™, at 1-800-829-7876.