

| (t) | |
|--------------------|---------------|
| 0-12mm (0-1/2") | 25mm (1") |
| 12-25mm (1/2-1") | 38mm (1 1/2") |
| 25-38mm (1-1 1/2") | 50mm (2") |
| 38-50mm (1 1/2-2") | 65mm (2 1/2") |

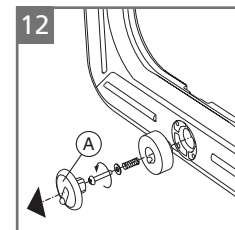
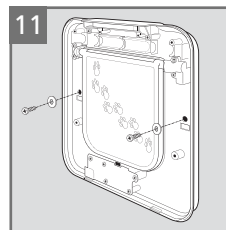
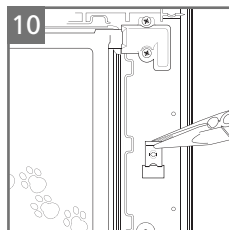
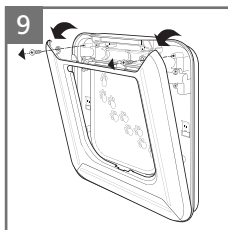
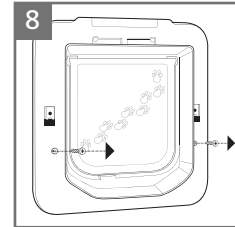
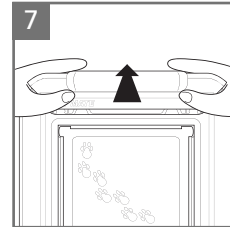

1. Wood / Plastic Door Panels 0-50mm (0-2") Thick

- 1.1 Place exterior frame in desired position on door and draw around the aperture. We recommend the bottom of the aperture is approximately 150mm (6") above ground level. (Fig. 1).
- 1.2 Use an electric jigsaw to cut 3mm (1/8") **OUTSIDE** of drawn line. (Fig. 2). Be careful to cut hole square to the door, particularly with thicker doors. Ensure interior frame is free fitting in hole.
- 1.3 Determine thickness of door panel, (t). (Fig. 3).
- 1.4 Holding the interior frame and the exterior frame in position, mark the 2 screw holes. (Fig. 4).
- 1.5 Remove the frames and drill screw clearance holes in panel to 6mm (1/4") diameter. (Fig. 5).
- 1.6 Position interior frame on inside of door and screw exterior frame to it by using appropriate screws for panel thickness, (t), as shown in Fig. 6. If necessary, cut supplied screws to length. Finally fit two screw caps.

2. UPVC / Metal Doors 0-50mm (0-2") Thick

Metal in the door can reduce the performance of cat flaps with I.D. Discs. To reduce this effect, the hole should be cut larger than for a standard door panel. NB: For 4-Way Locking Cat Flap, ref. 307, install as Section 1.

- 2.1 Place exterior frame in desired position, with the bottom of the aperture approximately 150mm (6") above ground level. Draw around the **OUTSIDE** of the frame. Using a jigsaw, cut 6mm (1/4") **INSIDE** this line.
- 2.2 The black foam seal in the exterior frame is not suited to fitting to metal and should be removed. If desired, the exterior frame may be sealed to the door using silicone sealant.

- 2.3 Position interior frame on inside of door, screw exterior frame to it by using appropriate screws for panel thickness, (t), as shown in Fig. 6. If necessary, cut supplied screws to length. Finally fit two screw caps.

3. Glass Panels 0-50mm (0-2") Thick

- 3.1 We recommend that you ask a glazier to cut a hole of 229mm (9") diameter in the position required and then install the cat flap as detailed below. Alternatively, you may prefer to replace the glass panel with a clear plastic panel and install as instructions 1.1 to 1.6.
Note: It is not possible to cut a hole in double glazed or toughened glass. You will need a new panel with the hole already cut from your glazier.
- 3.2 Determine thickness of door panel, (t). (Fig. 3).
- 3.3 The black foam seal is not suitable for fitting to glass and should be removed. If desired, the exterior frame may be sealed to the glass panel using silicone sealant.
- 3.4 Position interior frame on inside of door, screw exterior frame to it by using appropriate screws for panel thickness, (t), as shown in Fig. 6. If necessary, cut supplied screws to length. Finally fit two screw caps.

4. Wall Fitting

If you are installing your cat flap in a wall, you will need to purchase Elite wall liners. You will need 1 wall liner for every 50mm (2") of wall thickness over 50mm (2").

- 4.1 Create a rectangular hole in your wall 205mm (8") high by 180mm (7") wide.
- 4.2 Remove interior frame battery cover by pushing up as shown, (Fig. 7). **4 Way Locking Cat Flap (Ref. 307) only:** Remove the 4-way knob as shown in Fig. 12 using a thin screwdriver to lever off cover (A) as shown.

- 4.3 Remove interior frame cover by unscrewing 2 screws in rear of interior frame (Fig. 8). (*Note: these screws may be discarded as it will be impossible to refit them*). Next remove the 2 screws under the battery cover and remove the interior frame by pivoting down (Fig. 9).
- 4.4 Carefully remove 2 screw clips with pliers. (Fig. 10).
- 4.5 Fit interior frame assembled with requisite number of wall liners to interior wall securing in position with 2 suitable screws as shown in Fig. 11. (*Note: you will need to fit a washer (not supplied) under the head of the screws*). If required, the wall liners may be glued in place, although a firm push fit will usually suffice.
- 4.6 Refit interior frame cover with 2 screws under battery cover (and refit the 4-way knob for 4 Way Locking Cat Flap), taking great care not to trap electrical wires. Replace the battery cover.
- 4.7 Fit exterior frame using 2 off 25mm (1") screws supplied and finally, fit 2 screw caps.

GUARANTEE

Pet Mate Ltd. guarantee your product for a period of 3 years from the date of purchase, subject to proof of purchase date. The guarantee is limited to any defect arising due to faulty materials or manufacture. Any defective item will be repaired or replaced free of charge at the manufacturer's discretion, provided that the defect has not been caused by neglect, misuse or normal wear and tear. Your statutory rights are not affected.